



High definition IS Ethernet
camera for enhanced
visibility in hazardous areas

automatedcontrol

EATON

Powering Business Worldwide

automatedcontrol

SENSE | MONITOR | CONTROL



The first of a new generation

Providing additional safety and visibility in hazardous locations



Eaton's new **MTL RUGICAM-IP** High Definition (HD) Intrinsically Safe (IS) Ethernet network camera enables users across process industries worldwide to ensure they are operating safely in harsh and hazardous environments.

The first of its kind for the hazardous area market, the MTL RUGICAM-IP is ideal for remote monitoring using Internet Protocol (IP) connectivity and provides enhanced safety with clear visualisation of conditions in the process area. Its lightweight, compact and rugged design alongside simple mounting allows for easy installation wherever monitoring is required within a Zone 0, 1 or 2 hazardous area.

The MTL RUGICAM-IP offers flexible connectivity options for easy integration into the site network via WiFi or a compatible IS Ethernet network with a standard Cat5e cable. The fully IS design ensures safe device and network maintenance. WiFi connectivity provides an ideal solution for remote inspections via a hazardous area approved mobile device or for moving machinery applications. This reduces the risk for operators by eliminating the need to enter confined spaces or work in close proximity to moving machinery without compromising on the view of the critical equipment.

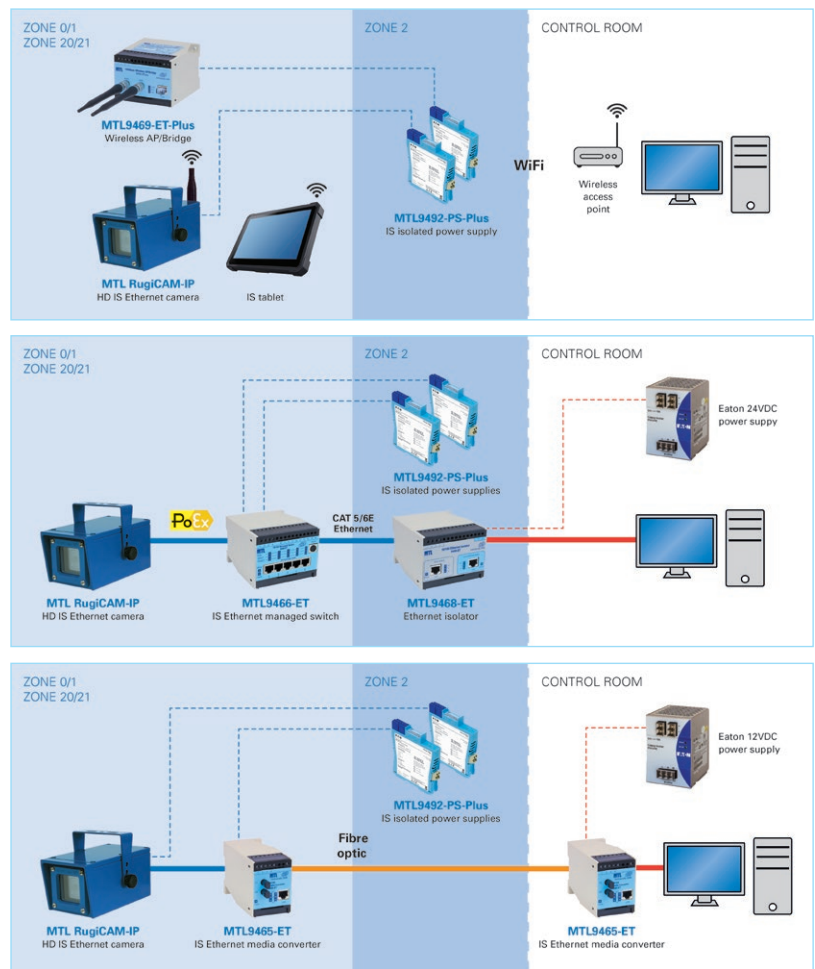

Key:
— Copper cable — IS copper cable --- IS power connection
— Fibre optic cable --- Power connection

Enhancing visual safety in hazardous areas

Providing extra security for safe operation

Easy integration into existing networks

Key features

➤ **Compact, rugged design** with IP66 rated enclosure for optimisation of space and minimum level of maintenance even in the harshest environments.

➤ **Ethernet or WiFi connectivity** allows easy access through the existing network infrastructure.

➤ **Full HD 1080P resolution** for high quality visualisation in process monitoring and inspections.

➤ **Video streaming & recording** supported with selectable frame rate to optimise network bandwidth usage and Micro-SD for local recording of trigger events.

➤ **Flexible powering** with unique PoEx™ feature providing power and communication over single cable.

➤ **Optional Infra Red (IR) or white LED accessories** provide high quality images in low light locations.



MTL RUGICAM-IP LED unit



MTL intrinsically safe power supplies



The 949x-PS-PLUS range of MTL Intrinsically Safe (IS) isolated power supplies are ideal for providing power to the MTL RUGICAM-IP and instrumentation in hazardous process areas.

The 949x-PS-PLUS range can be used with the 946x-ET range of MTL IS Ethernet devices to provide direct IS power or Power over Ethernet (PoEx™), a method which allows a single cable to provide both the data connection and electrical power to devices, reducing installation costs.

They also offer a wide range of different IS output voltages, ranging from 4.8V - 17.7V, delivering flexible options for a variety of applications.

For further information about Eaton's new MTL RUGICAM-IP, please contact your local sales office or visit www.mtl-inst.com



EATON Crouse-Hinds series

The safety you rely on.

See the complete MTL industrial network solutions product portfolio at www.mtl-inst.com

For more information:

If further assistance is required, please contact an authorised MTL Distributor, Sales Office, or Customer Service Department

 automatedcontrol

3/4 Birraba Ave, Beresfield NSW 2322

Ph 02 4964 4022 | Fax 02 4028 6770

www.automatedcontrol.com.au

Measurement Technology Limited

Great Marlings, Butterfield, Luton
Beds LU2 8DL, UK.

Tel: + 44 (0)1582 723633 Fax: + 44 (0)1582 422283

E-mail: mtlenquiry@eaton.com

www.mtl-inst.com

EATON

Powering Business Worldwide

© 2016 MTL
All Rights Reserved
ZL-B-RugiCam-EN-0116
January 2016

Measurement Technology Limited

Great Marlings, Butterfield, Luton
Beds LU2 8DL, UK.
Tel: + 44 (0)1582 723633 Fax: + 44 (0)1582 422283
E-mail: mtlenquiry@eaton.com
www.mtl-inst.com

Eaton is a registered trademark.

All other trademarks are property
of their respective owners.

 automatedcontrol

SENSE | MONITOR | CONTROL