

Flow meter for gaseous media



vent-captor system 3505 + 3022.30/xx

The **vent-captor** type 3505 + 3022.30 is a remote flow meter for industrial applications, ideal for small pipe sizes. The measurement of the mass flow bases on the calorimetric principle. The vent-captor is completely resin encapsulated, thus rugged, shock and vibration proof.

- Small pipe diameters
- **Standard ID 13 mm (ID 10 - ID 15)**
- For air and other gaseous media
- Ideally suited for low flow rates
- Temperature compensated
- Compact, no additional parts
- Linear current output 4 -20 mA
- LED for range control
- Rugged industrial version
- **ISO 9001:2008**



Technical Data

Typ	3505 + 3022.30/xx			
Medium	gaseous (agressive media on request)			

Sensor Data *1

Measuring range	0 - 10 m/s	0 - 20 m/s	0 - 30 m/s	0 - 50 m/s
Measuring at ID 13 mm	0 - 80 l/m	0 - 160 l/m	0 - 240 l/m	0 - 400 l/m
Measuring range adjustment	continually adjustable from 20 % to 100 % of the specified measuring range 2 potentiometers (zero point, range)			
Linearity deviation	< 3% best fitting slope			
Repeatability tolerance	< 1%			
Temperature drift	< 0,3% / K			
Medium temperature	-20 °C to +70 °C			
Ambient temperature	-20 °C to +70 °C			
Pressure (3505)	max 16 bar			

Mechanical Data

Protection class	IP 65			
Material	Sensor probe Ceramic, Platinum with overglaze	Sensor holding PET	Sensor housing stainl. steel WN 1.4571 AISI 316Ti	Electronic housing Makrolon®
Sensor connection	moulded oilflexcable / 3 x 0,5 mm ² , length 65 cm			
Housing dimension and connection diagram	see back page			

Electrical data

Operating voltage	24 V DC ±10%
Current consumption	4,3W - 5,3W (max. flow)
Output current	4 - 20 mA
Load	0 - 600Ω

*1 All data for medium air with normal atmospheric pressure

weber

Sensors Ltd. · Strohdreich 32 · D-25377 Kollmar · Tel.: +49 4128-591 · Fax: -593 eMail: info@captor.de

Technical data subject to alteration! Rev. AK/ 02.02.16

Flow meter for gaseous media



vent-captor system 3505 + 3022.30/xx

Dimensions:

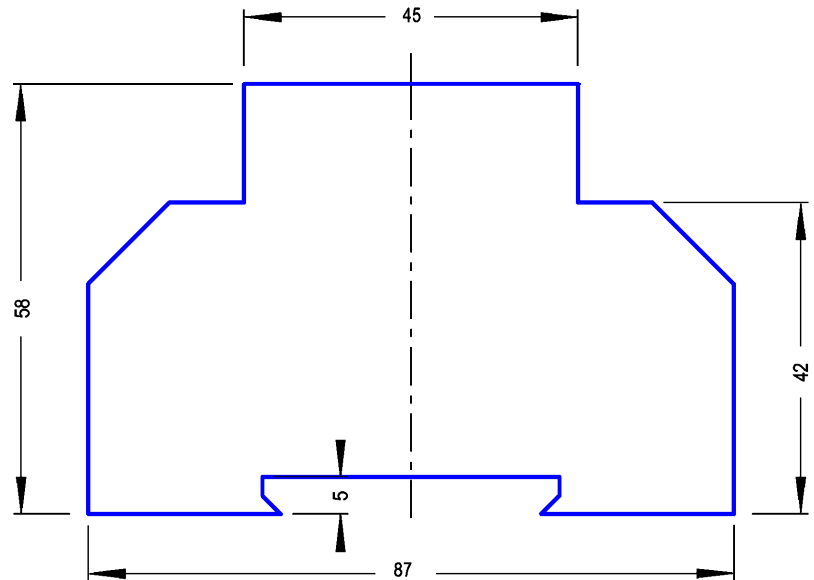
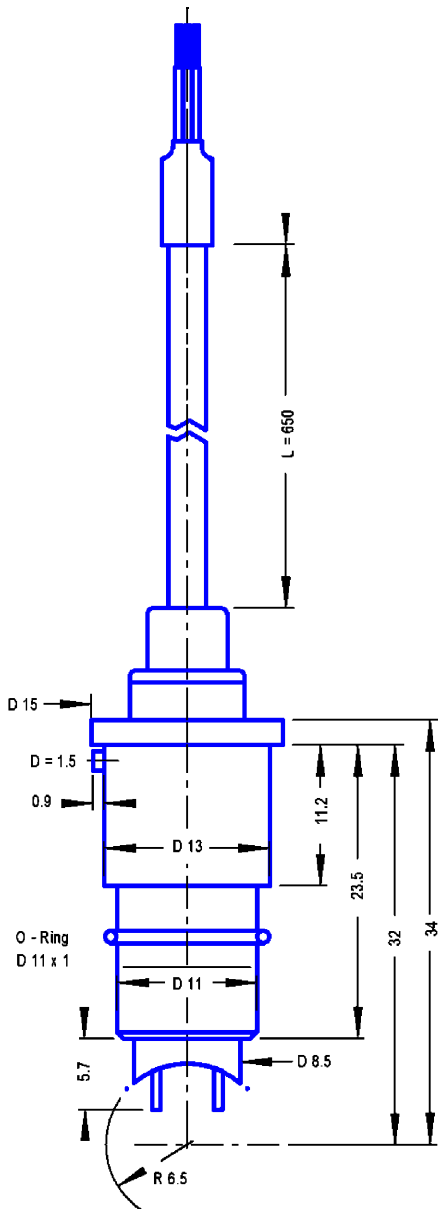

dimensions (HxLxD): 58x87x18 mm

Connection diagram:

