

Industrial Matrix Drive U1000

5 to 350 HP

U1000 Dimensions & Specifications

Open Chassis
(IP00)

240 V Class			Dimensions (inches)				Weight (lb)
Model: CIMR-UU2A□	Amps ND / HD	HP ND / HD	Fig. No.	H	W	D	
0028AUA	28 / 22	10 / 7.5	1	18.89	9.84	14.17	44
0042AUA	42 / 28	15 / 10		71			
0054AUA	54 / 42	20 / 15		77			
0068AUA	68 / 54	25 / 20					
0081AUA	81 / 68	30 / 25					
0104AUA	104 / 81	40 / 30	2	32.12	10.39	17.71	132
0130AUA	130 / 104	50 / 40	3	38.97	16.33	15.86	245
0154AUA	154 / 130	60 / 50					
0192AUA	192 / 154	75 / 60					
0248AUA	248 / 192	100 / 75		44.56	19.29	17.71	388

480 V Class			Dimensions (inches)				Weight (lb)
Model: CIMR-UU4A□	Amps ND / HD	HP ND / HD	Fig. No.	H	W	D	
0011AUA	11 / 9.6	7.5 / 5	1	18.89	9.84	14.17	44
0014AUA	14 / 11	10 / 7.5					
0021AUA	21 / 14	15 / 10					
0027AUA	27 / 21	20 / 15					
0034AUA	34 / 27	25 / 20		25.60	10.39	16.53	71
0040AUA	40 / 34	30 / 25					
0052AUA	52 / 40	40 / 30					
0065AUA	65 / 52	50 / 40					
0077AUA	77 / 65	60 / 50	2	32.12	10.39	17.71	132
0096AUA	96 / 77	75 / 60					
0124AUA	124 / 96	100 / 75	3	38.97	16.33	15.86	245
0156AUA	156 / 124	125 / 100					
0180AUA	180 / 156	150 / 125					
0216AUA	216 / 180	175 / 150					
0240AUA	240 / 216	200 / 175					
0302AUA	302 / 240	250 / 200					
0361AUA	361 / 302	300 / 250	44.56	27.36	17.71	571	
0414AUA	414 / 361	350 / 300					

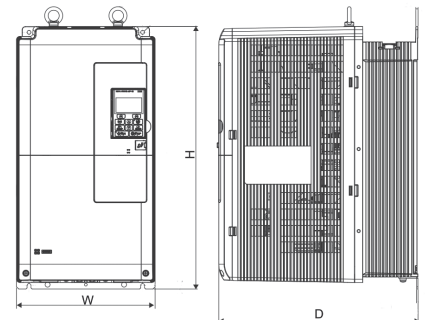

Figure 1

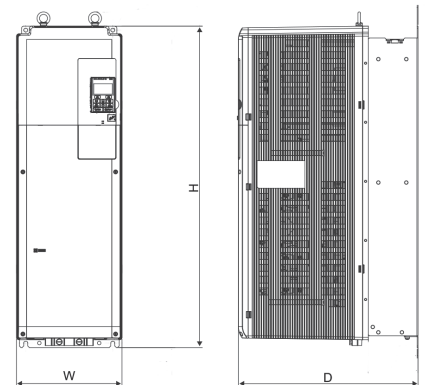

Figure 2

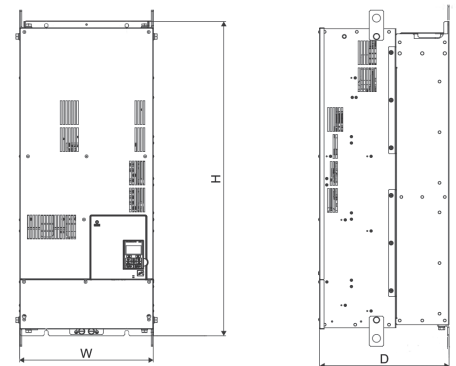
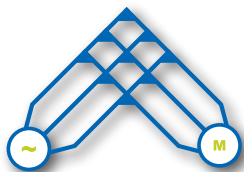

Figure 3



U1000 MATRIX INNOVATION

Improved Energy Efficiency with Direct Conversion from AC to AC